

# Oceanic

## Turkish Steam Room Information Pack



# Oceanic





## Over 30 Years of Experience

Oceanic offer a new range of ready to assemble Turkish steam rooms made from top quality materials suitable for domestic and commercial use at unbeatable prices.

35 years of experience manufacturing and installing saunas and steam rooms has enabled Oceanic to develop an innovative range of Turkish steam rooms that are easy to assemble and customise to fit a wide range of domestic and commercial spaces.

We have concentrated on the things we know you will find most important – thanks to the use of Marmox Multiboards and our intelligent Oceanic Steam Generator you can now rely on fast heat up times and lower heating bills, saving you time and money whilst reducing energy waste keeping our planet green.

## Innovative Design For Installation

Not only have we standardised many of the components we have also epitomised the sizes so that as little material as possible is wasted and therefore cutting down the cost. In addition we have thought through and simplified the assembly procedure for quicker and easier installation.

All the steam rooms in this range have been designed and developed so that any competent trades person can assemble, install and modify to suit the space. Even the position of the door can be changed.

## Versatile, Self Contained Units

The integral floor makes life easier in areas where drainage could be a problem. A 1.5" drain pipe will be required at low level however with the use of shower waste pumps [e.g Saniflo] it is now possible to install our steam room in a basement or garage and have the waste water pumped up to 5 metres vertically or



50 metres horizontally. There is a step up to the integral floor of 128mm.

For locations where it is preferable not to have a step such as commercial establishments where wheelchair access is needed or in bathrooms or spas where designers & architects prefer a consistent floor level throughout the building all of the Oceanic range can be specified without the integral floor and erected directly onto the site floor provided suitable drainage has been installed

To see for yourself the range of models and how easy they are to install all of the drawings and instruction manuals are available online at: <http://www.thebathingplace.com/>

If the steam room you require is not in our standard range please contact our bespoke installations department: 01902 450550

# Oceanic

## Features

### In built floor and drainage

All steam rooms comes with a sloping floor tray and drain as standard which allows the rooms to be installed almost anywhere. It is even possible to install in a basement with a pump connected to the waste drain.

### Barrelled ceiling and curved benches

All models are designed with elegant half or fully arched ceilings. As well as being more attractive than a standard sloped ceiling the curved ceiling prevents any water dripping and is easier to tile.

Ergonomically shaped benches provide enhanced comfort and appearance.

### Proprietary brand materials

Marmox multiboard reduces the need for tanking and speeds up installation time and the BAL flexible adhesives make the tiling easier and improve the performance of the room.

### Intelligent steam generator

The robust Oceanic steam generators are built for both commercial and domestic environments. The heating elements are intelligently controlled to ensure the generator is running at maximum efficiency prolonging the lifetime of the elements whilst reducing energy costs.

The waterproof digital controller allows the user to set the time, temperature, lighting and even drain the generator from inside the unit.

### Aromatherapy

Domestic generators have a smart steam inlet nozzle with the facility to accept essential oils. For commercial operations we suggest a fragrance pump.

### Commercial Operation

For commercial use a heavy duty generator is supplied with an autodescale function and the innovative energy saving Steam On Demand function. This feature is excellent for during quieter periods of the day, users inside the room can use this button to activate the generator to produce steam for 30 minutes.

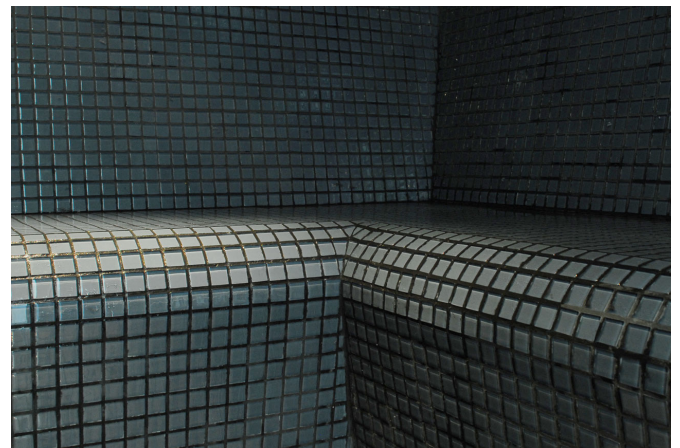

**marmox**  
**multiboard**  
Waterproofing • Insulating • Drylining





## Materials and Components

The rooms are constructed from the highest grade Marmox waterproof board and come complete with all the necessary parts and accessories to complete the installation, including:

- Steam generator, controller, temperature sensor
- Chrome steam outlet, steam guard, steam door
- Drain fitting and all associated pipe work, drain tile
- Adhesive, grout, silicone, sealer, tiles, boarder tiles
- Chrome IP65 light and transformer
- Vent kit

## Tiles

All models are supplied with the choice of travertine, white marble natural stone, coloured glass or iridescent mosaic mosaics. See below for full selection. Alternatively purchase without tiles, grout and adhesive in order to match the steam room with your existing decor.

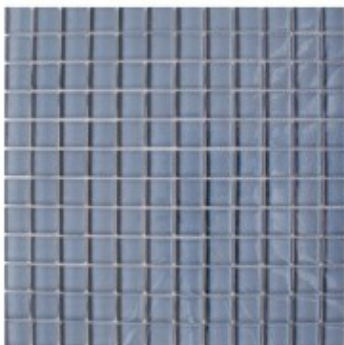

Slate Grey - Glass

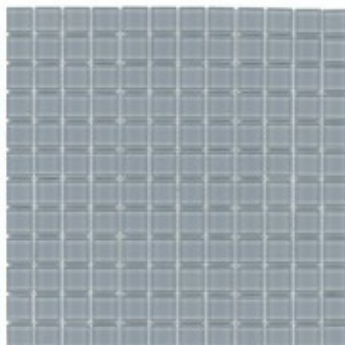

Light Grey - Glass

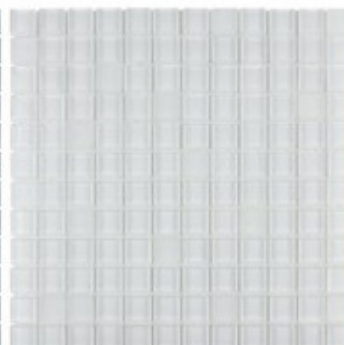

White - Glass



Light Blue - Glass

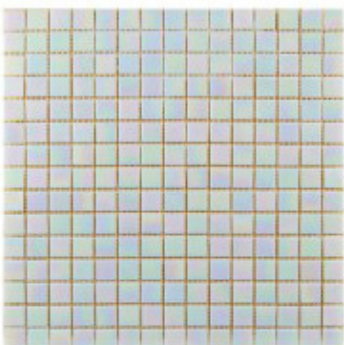

Pearl White - Iridescent

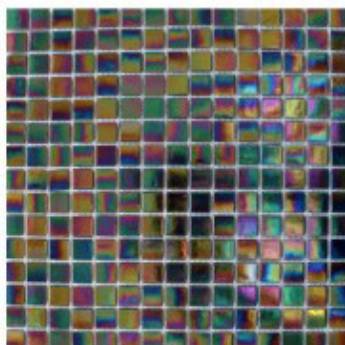

Petrol Balck - Iridescent

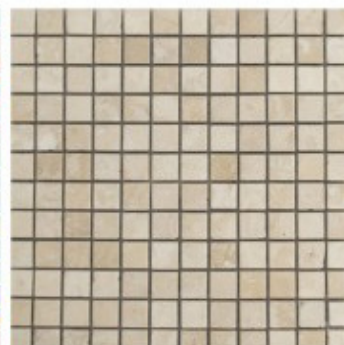

Travertine - Natural Stone



Star White -Natrual Stone

The door is available with either a bright white or polished chrome finish.

## Installation

With our simplified and detailed instructions all of the cabins in our standard range are suitable for installation by a local builder eliminating the need for specialist installers having to travel long distances and their overnight accommodation costs; for customers who prefer to have their installation done by our installers this can be arranged in most areas.

We have produced simple smart information packs for each model which can be downloaded from [thebathingplace.com](http://thebathingplace.com) and printed for your use. Specification sheets also show accurate line drawings and individual product features.

The instructions include details for modification and resizing the rooms if necessary.

Our designs are intended to integrate easily into your plans and the final aesthetic appearance of the room can be finished to meet your expectations. [download our DWG, SKP, PDF floor plans for your architect]

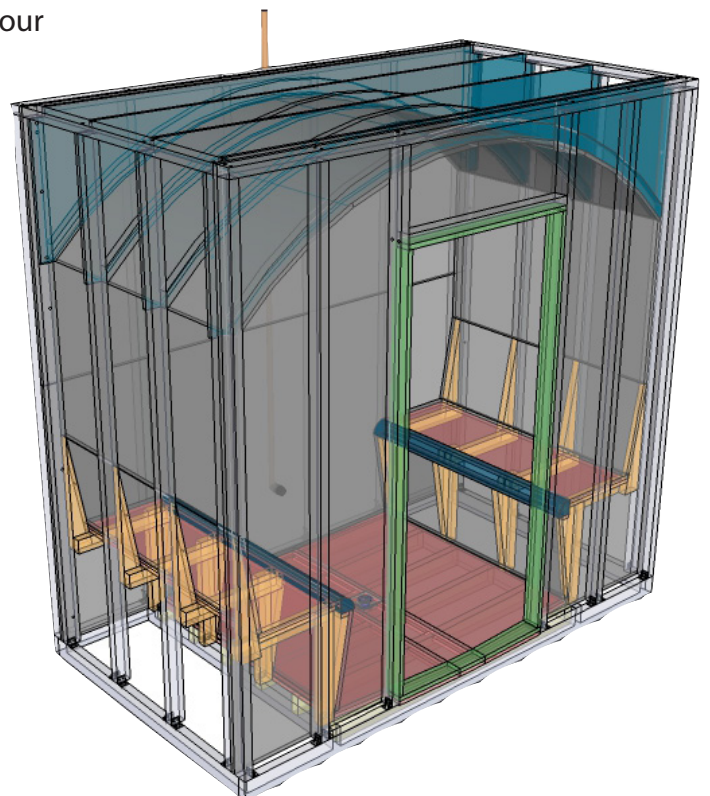



## Bespoke Service

For customers with special requirements we offer a custom design service. Oceanic will design, manufacture and install Sauna, Steam and spa equipment for domestic and commercial use. With over 40 years of experience we are able to accommodate almost all requirements, whether it be a small domestic sauna to fit into a tight space or custom designed commercial wet room containing a combination of saunas, rasuls, steam rooms.

Our standard range of sauna and turkish steam room can be modified to suit alternative space requirements. For commercial turkish steam rooms we offer a flat rate for modifying the size depending on the number of dimensions that need to be reduced.

We source our own range of mosaic tiles that we offer at very competitive prices and are ideal for us in wet room environments. Oceanic also offer fully glazed panels and doors.

We are happy to work with architects, interior designers, developers, contractors or directly with the end user. We can provide detailed 3D drawings of our equipment if required.

For any information on bespoke designs and custom installations please contact our design team on: 01902 450 550 or email: [peter@oceanic-saunas.eu](mailto:peter@oceanic-saunas.eu)

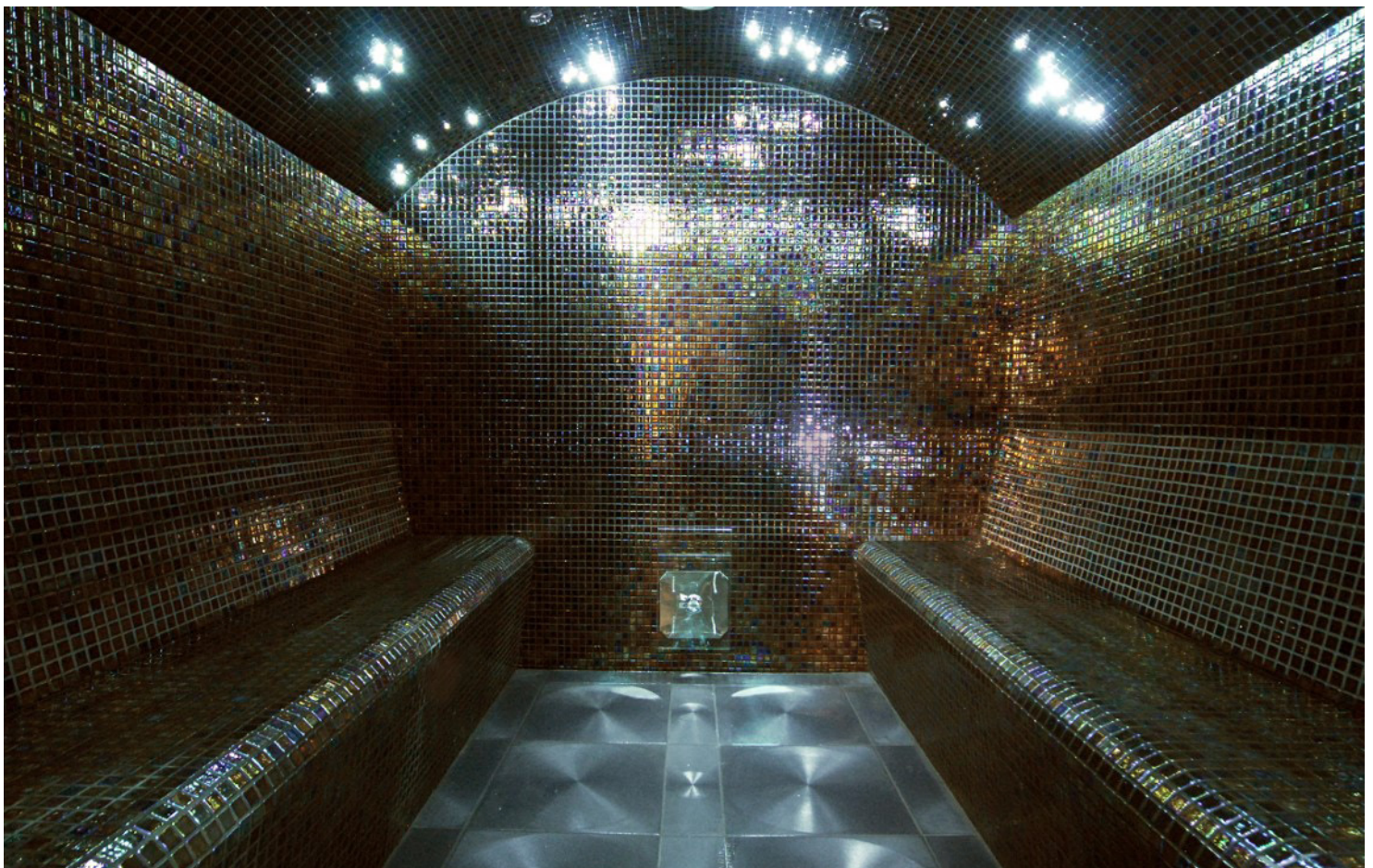

# Oceanic

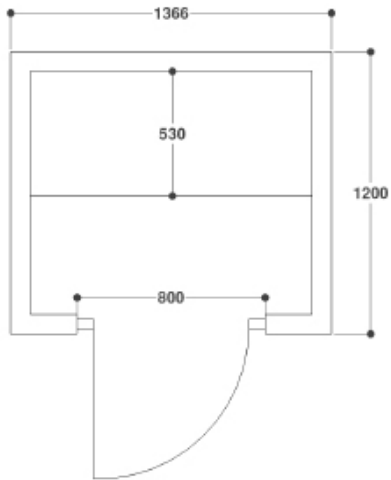

## **Model 1 1366 x 1200 x 2400mm**

Minimum dimensions: 900 x 1000 x 2088mm  
4kw Oceanic Steam Generator

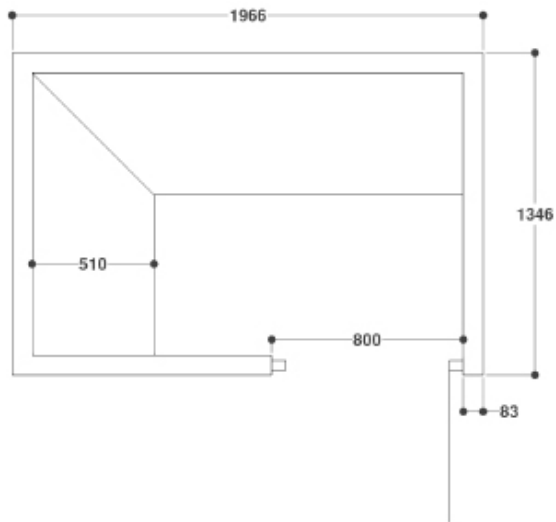

## **Model 2 1966 x 1346 x 2400mm**

Minimum dimensions: 1496 x 1000 x 2088mm  
6kw Oceanic Steam Generator

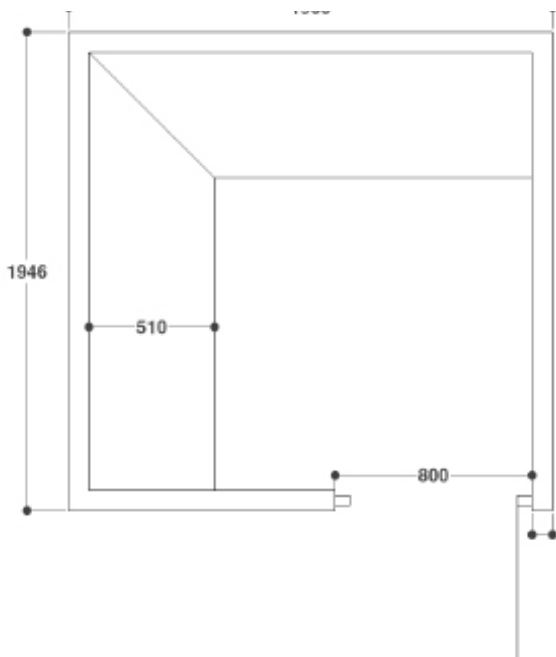

## **Model 3 1966 x 1946 D x 2400mm**

Minimum dimensions 1496 x 1000 x 2088mm  
8kw Oceanic Steam Generator



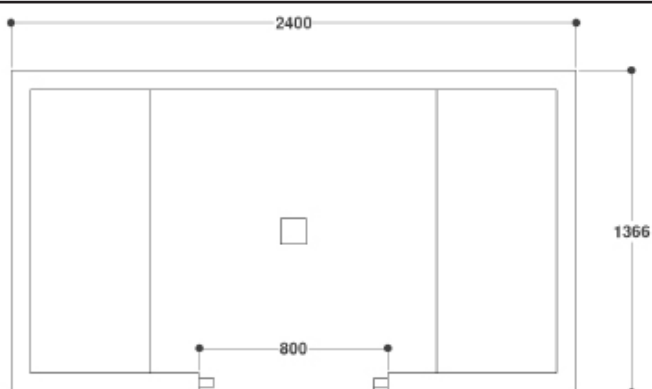

#### **Model 4 2400 x 1366 x 2400**

Minimum dimensions: 2026 x 800 x 2088mm  
8kw Oceanic Steam Generator

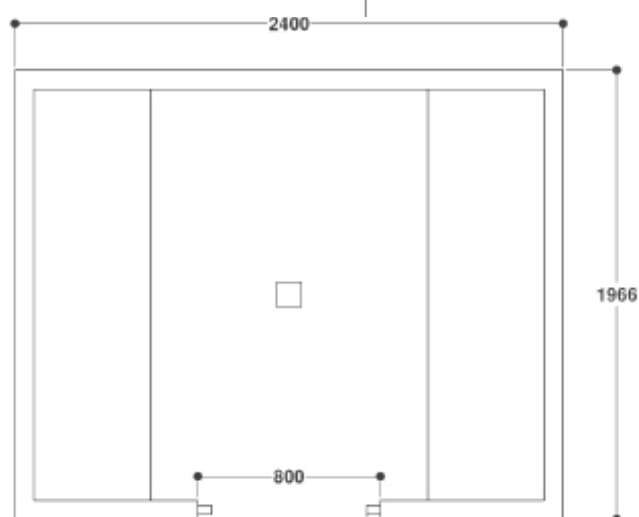

#### **Model 5 2400 x 1966 x 2400**

Minimum dimensions: 1496 x 1000 x 2088mm  
9kw Oceanic Steam Generator

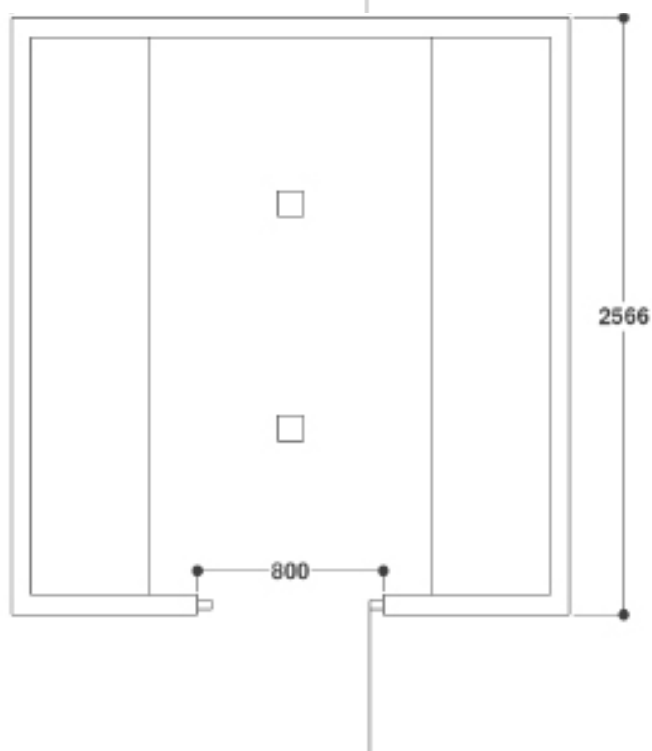

#### **Model 6 2400 x 2566 x 2400**

Minimum dimensions: 1496 x 1000 x 2088mm  
10.5 kw Oceanic Steam Generator

For more information including full sets of detailed drawings, individual specification sheets, installation instructions and modifications please visit The Bathing Place website: [www.thebathingplace.com](http://www.thebathingplace.com) or contact our sales team.