

Heavy Duty Sauna Range

Unique Features

The heavy duty range of saunas are built for commercial use and include a number of features that will reduce maintenance, running costs and prolong the life of the cabin.

Behind Bench Heater

An option for all heavy duty cabins is the behind bench heater, a wall mounted unit that is located behind a false wall at the rear of the cabin. There are many advantages of this model of heater.

Protected heating elements

The heating elements are located directly beneath the rock tray in the behind bench heater. This prevents water being splashed directly onto the elements which is a common cause of element failure in standard sauna heaters.

A water dish and hose are fitted with the behind bench heater, users pour water into this dish mounted behind the false wall and the water is distributed evenly across the rocks. Water thrown behind the bench will also be collected by the rock tray and will never fall directly onto the elements.

Safer Use

Having the heater hidden out of the way behind a false wall and beneath the benches prevents any accidental injuries from users being able to come into contact with the hot surfaces of the heater itself.

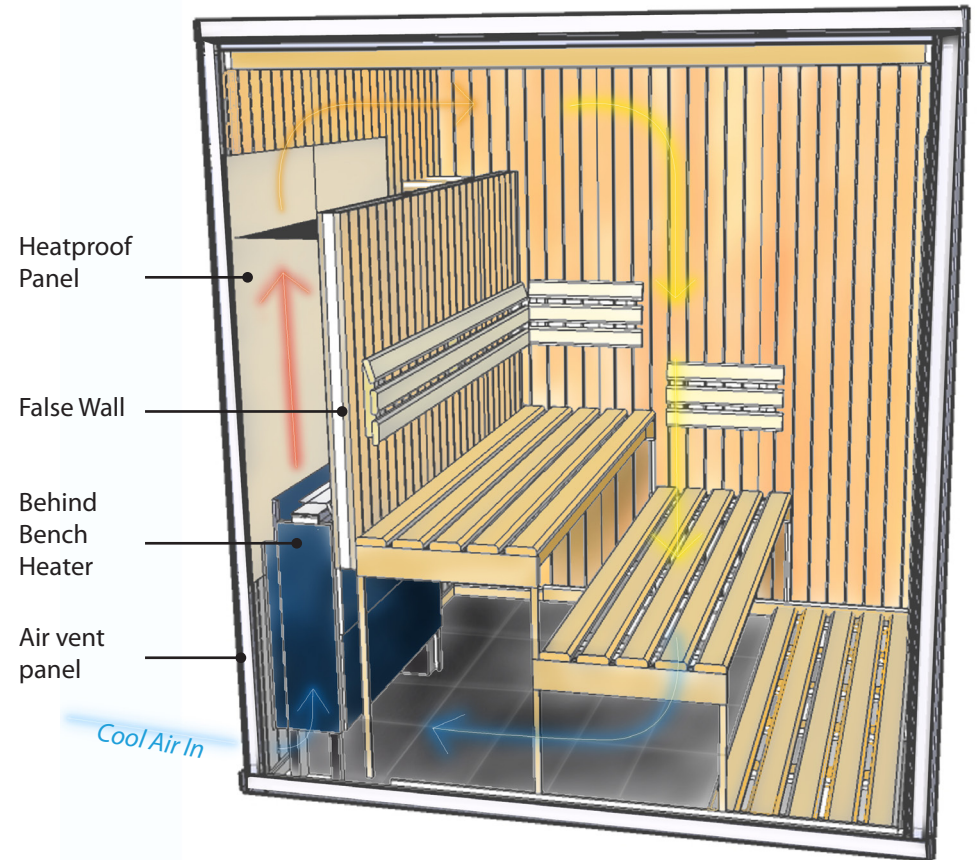

Heavy Duty Cabin Section

Cool air is drawn in from beneath the heater through the vent panel behind. The hot air circulates by rising from above the false wall then falling down through the benches.

Heavy Duty Sauna Range

Oceanic

Unique Features

Auto dosing

It is simple for this model of sauna heater to be fitted with an auto dosing pump to control the amount of water being added to the rocks remotely and prevent the need for users to interfere with the heater. This further prolongs the life of the heater and provides the client with better management of the conditions within the sauna.

Double Insulated Wall Panel

All wall panels are filled with Rockwool and lined with an aluminium sheet to provide two layers of insulation improving efficiency, reducing the energy requirements and prolonging the life of the heater.

The base is treated with a water resistant tanking solution so that the cabin does not absorb water when the floors are cleaned with mop and bucket. The hidden nail profile of the knot free spruce panels creates a clean flawless internal finish to the cabin.

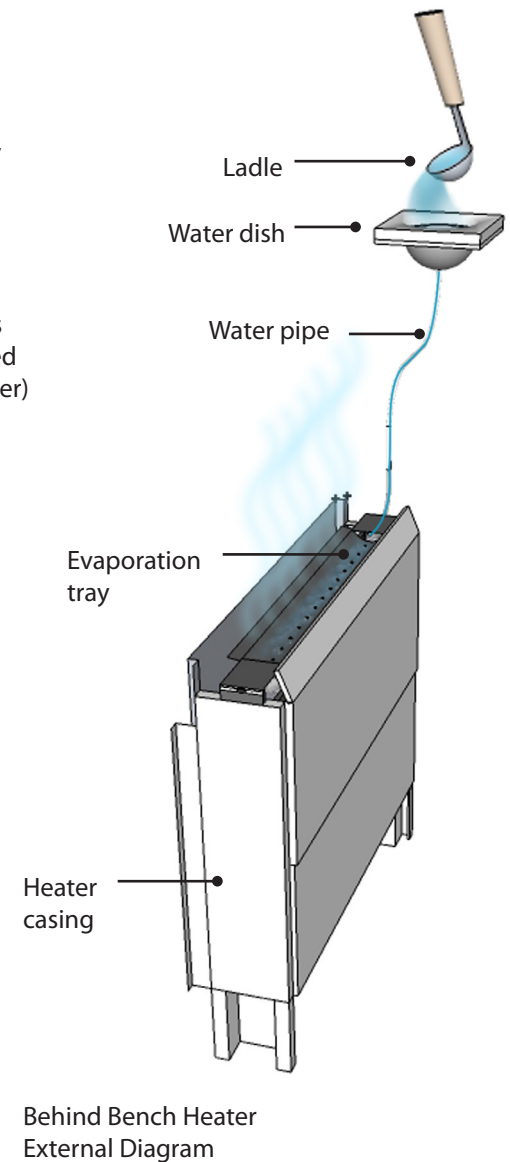
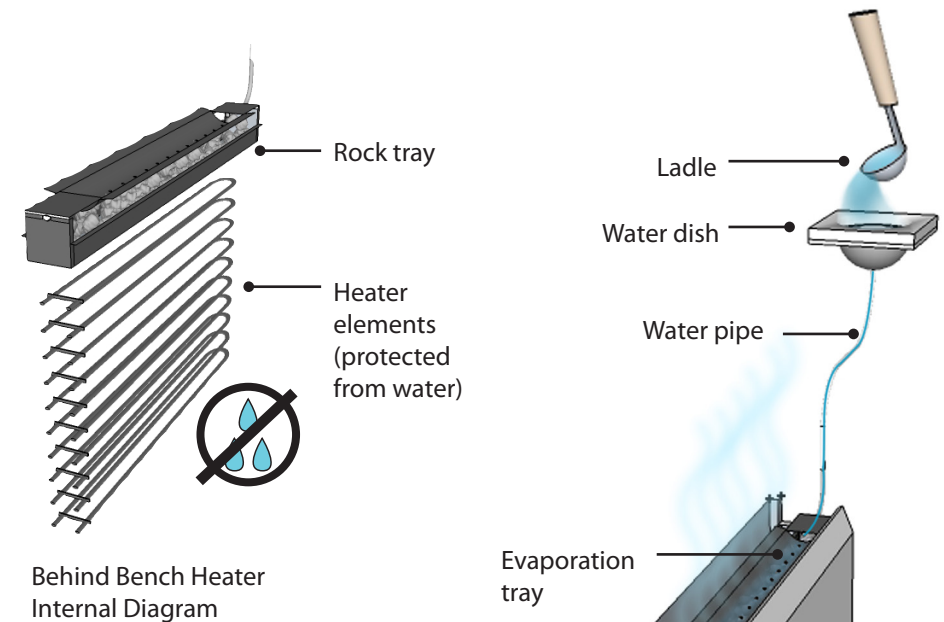
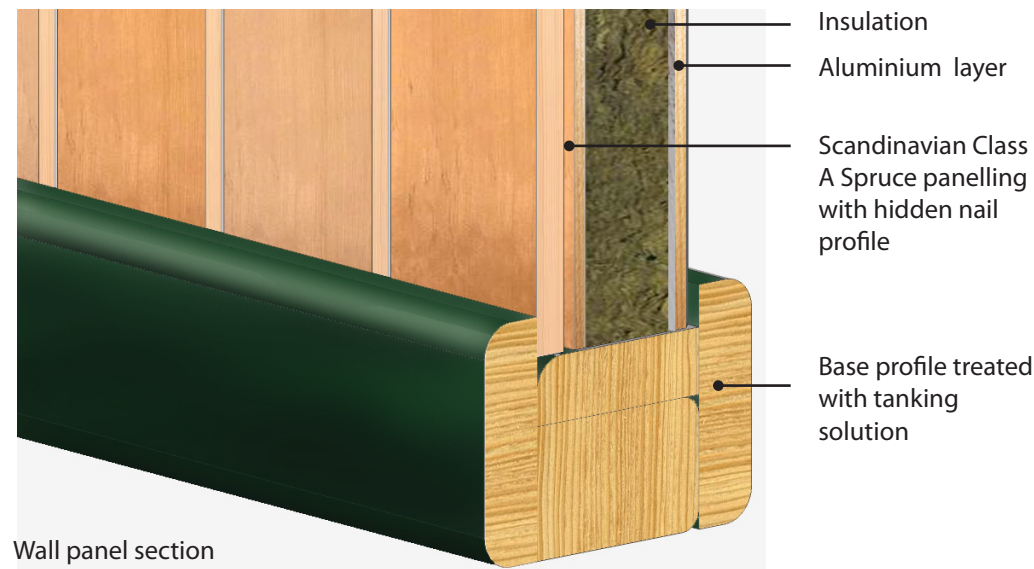

Heavy Duty Sauna Range

Unique Features

Heat resistant panels

To avoid scorching of the timber panel behind the heater unit all heavy duty cabins are supplied with heat resistant panels. As an optional feature the panels can also be lined with a mosaic tile for a bespoke aesthetic.

Optional mosaic
tile feature wall

Thicker bench timber

25mm thick Spruce timber is used in the heavy duty range to give a more durable and stronger benches.



Heavy duty bench

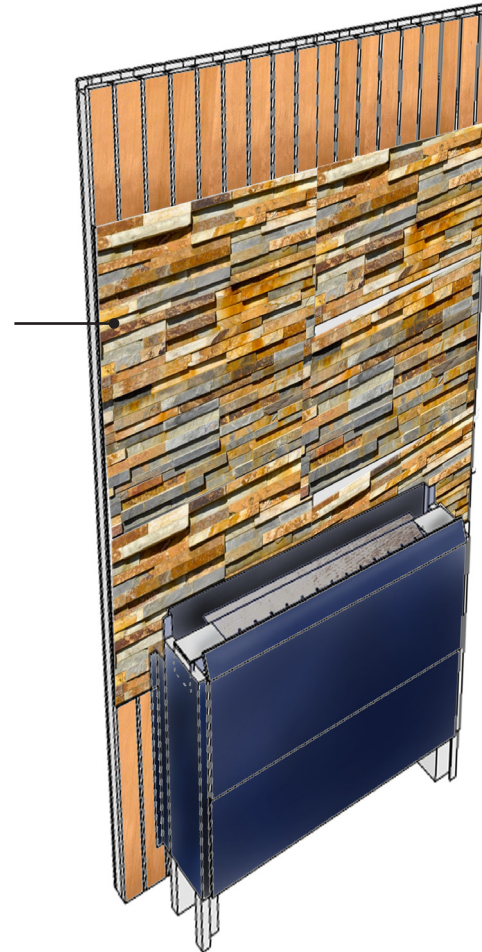

Example heat damage behind sauna heater